



Arroyo™ Outlet Channel

High-Capacity Sheet Molded Perimeter Drain

Product Information Sheet

Poly Wall® Building Solutions is an innovator of high-quality, cost-effective, engineered building materials. We stand behind our brand promise — **Moisture and Air Stop Here®**. Visit our website at www.poly-wall.com for the full array of products.

DESCRIPTION

Poly Wall® Arroyo™ Outlet Channel is a prefabricated, high-capacity sheet molded perimeter drainage system constructed using a formed polystyrene core, designed specifically to transition water collected from sheet drains to an outlet drain.

USES

Arroyo Outlet Channel is used for below-grade relief of hydrostatic pressure over foundation and retaining walls.

Basic post-applied perimeter drainage and protection course uses include the following:

- Sheet-applied waterproofing
- Fluid-applied waterproofing



ADVANTAGES

- The high-profile Arroyo Outlet Channel section has a larger open area than perforated pipe, allowing it to accept higher water flow from the sheet drain and surrounding soil.
- Arroyo Outlet Channel, with its manufactured transition between the sheet drain and high profile section, provides a secure flow path not dependent upon as a field-installed connection, as with the perforated pipe.
- The Arroyo Outlet Channel System is fast and easy to install. It eliminates the select backfill requirements normally required to provide strength to perforated pipe.

WHY USE POLY WALL® ARROYO™ OUTLET CHANNEL?

- Allows you to create a complete, functioning and properly detailed water removal system.
- 60 years of successful waterproofing experience.
- Poly Wall is an employee owned company, where employees expect more of themselves and the company.
- Made in the USA.
- See more online, visit us at www.poly-wall.com.



POLY WALL® BUILDING SOLUTIONS:
Moisture and Air Stop Here®
888-976-POLY (7659) • www.poly-wall.com





High-Capacity Sheet Molding Perimeter Drain

LIMITED WARRANTY: Poly Wall Building Solutions will replace F.O.B. Ennis, TX, any material with manufacturing defects which cause leaks for a period of 1 year from date of purchase. Poly Wall Building Solutions will not be liable for any other claims or damages, whether direct or indirect, including consequential damages or incidental damages.

Packaging Information

DRAINAGE & ACCESSORIES	PART #	UNIT SIZE
Arroyo Outlet Channel	PWAOC.24.50	24" X 50' roll
Arroyo Outlet Channel End Outlet (4")	PWENDOUTLET	End=5" x 5" x 9"
Arroyo Channel Tee Outlet (4")	PWTTEEOUTLET	T=7-1/2 x 6-1/4 x 6-3/4"
Polybond Clear Liquid Adhesive	POLYBOND5G	5 gallon pail
Polybond Clear Liquid Adhesive	POLYBOND1G	4 - 1 gallon pails/ctn
Shur-Tac Water Based Adhesive	SHUR-TAC1	4 - 1 gallon pails/ctn
Shur-Tac Water Based Adhesive	SHUR-TAC5	5 gallon pail



Arroyo End Outlet Channel



Arroyo Tee Channel Outlet

Arroyo™ Outlet Channel Properties

Property	Test Method	Typical Value
FABRIC		
Material ¹		PP
Water Flow Rate	ASTM D 4491	150 gal/min/ft ²
Grab Tensile Strength	ASTM D 4632	115 lbs.
Puncture Resistance	ASTM D 4833	70 lbs.
Apparent Opening Size	ASTM D 4751	70 sieve
Permittivity	ASTM D 4491	2.2 s ⁻¹
Grab Elongation	ASTM D 4632	70%
UV Resistance	ASTM D 4355	70% / 500 hrs.
Sheet Section	ASTM D 4716	21 gal/min / ft ²
High Profile Section	ASTM D 4716	150 gal/min/ft ²
CORE THICKNESS		
Sheet Section		.44 inch
High Profile Section	ASTM D 1777	1.0 inch
Comprehensive Strength	ASTM D 1621	9,000 psf.
Flow Rate ²	ASTM D 4716	21 gpm/ft
Recycled Content		78%

1 - PP - Polypropylene; HIPS = High Impact Polystyrene
 2 - In plane flow rate measured at 3,600 psf (172 kPa) compressive load and hydraulic gradient of 0.1

INSTALLATION GUIDELINES FOR POLY WALL® ARROYO™ OUTLET CHANNEL

The installation guidelines provided below are not intended to be full and complete application instructions.

For full application directions scan here



VERTICAL INSTALLATION

- Over post-applied sheet- or fluid-applied waterproofing, place the fabric side to the interface with the back-fill material.
- The first row of drain to be installed is the Arroyo Outlet Channel at the bottom of the wall. The drain should sit on top of the footing with the high-profile part of the drain at the bottom to provide high lateral water flow.
- Attach Arroyo Drain Board sheet to top portion Outlet Channel and run up the wall attaching with spot adhesive for full wall coverage.

STEP 1 - Placement

- When full wall drainage is required, tie-in Arroyo Drain Board Sheet Molded Drainage to the top edge of the Arroyo Outlet Channel. Butt adjacent panels together with tape, recommended adhesive, or by peeling back fabric and interlocking at least two rows of dimples; and then overlap fabric and tape or secure with glue to prevent soil or concrete intrusion.
- If not using Arroyo Drain Board for full wall coverage, close the top end of the drain to prevent soil intrusion by folding the fabric behind the drain.

STEP 2 - Recommended Adhesives

- Adhere Arroyo Outlet Channel to the face of post-applied sheet- or fluid-applied waterproofing membrane using either Polybond Clear Liquid Adhesive, Shur-Tac or another low-rise spray adhesive that is compatible with the sheet or fluid membrane.
- Arroyo Outlet Channel Tee and End Outlet Fittings are available for transitioning to a hard pipe system.

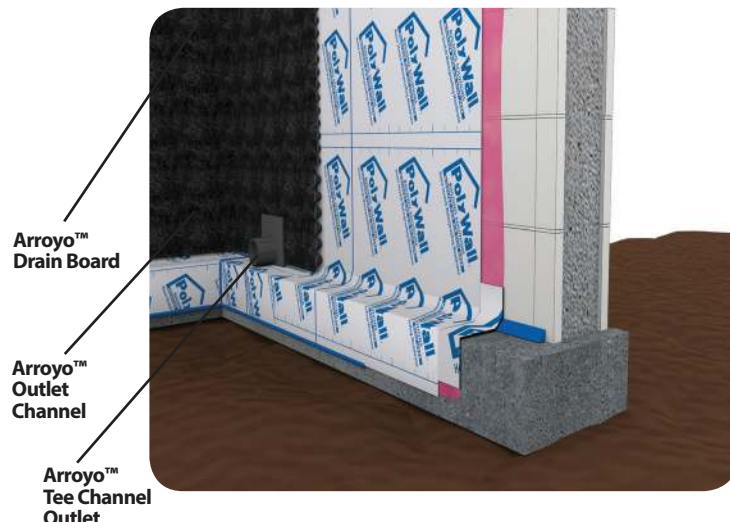

POLY WALL BUILDING SOLUTIONS:
Moisture and Air Stop Here®

888-976-POLY (7659) • www.poly-wall.com